

**Terrell Independent School District**

**Date:** Friday, November 30, 2018

**Project:** Ag Barn Pasture Fence

**Quote Deadline:** Friday, December 14, 2018, 4:30pm

**Scope of work:** To follow.

Please direct all questions to Jeff Baska.

If for some reason you are unable to bid on the project please contact us with a NO BID response by fax or email.

Thank you,

Jeff Baska  
Facilities Director  
Terrell ISD  
Jeff.baska@terrellisd.org  
972-563-2424  
972-563-4749 fax

Terrell ISD

Ag Barn Pasture Fence Project

November 30, 2018

1. Approximately 1085 lf of new fencing. Contractor to field verify before quoting.
2. All corners, gate posts and mid-point tension posts shall be 2 3/8 steel pipe welded "H" posts.
3. Heavy ga. 6' T-posts are to be 10' on center with "Twistys" mid-point between T-posts.
4. Fencing fabric to consist of Red brand "Keep Safe" V mesh, or an equivalent "No Climb" type fence will be considered.  
2 strands of smooth 12.5 ga horse wire above and below fence fabric.  
"Twistys" at mid-point between T-posts.

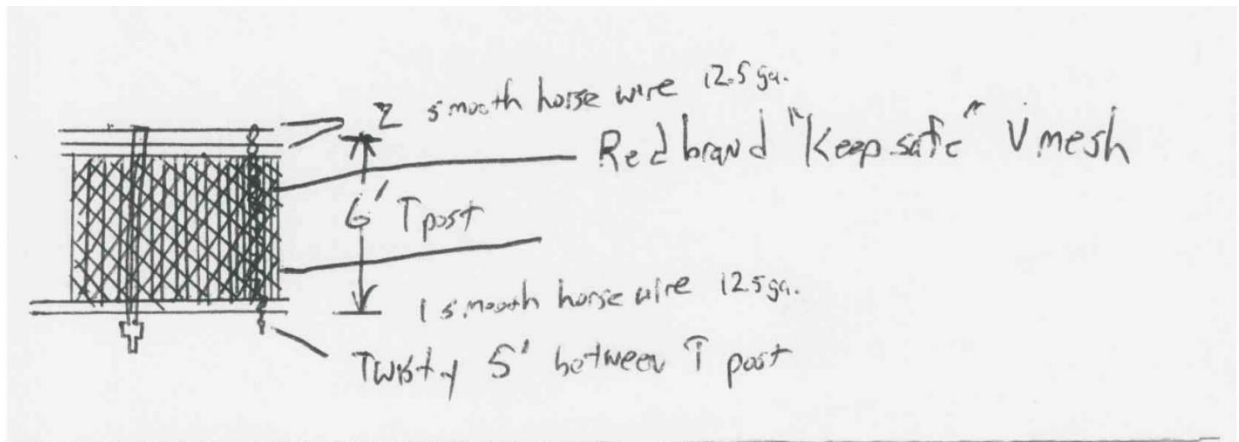

Note: Some older existing fence in some areas may be demolished and replaced with the fencing specified above. Please provide a quote per l.f. for additional demolition and fencing as specified.



search...

FENCE GEAR TOOLS ACCESSORIES

Home » Horse Fence » Keepsafe® V-Mesh Horse Fence 58-in. - 165-ft.



Click above image for larger view



### Keepsafe® V-Mesh Horse Fence 58-in. - 165-ft.

\$451.49

Add to Cart

Shipping & Tax applied at checkout

Tweet

Like

Save

#### Customer Reviews

Based on 2 reviews [Write a review](#)

#### Product details

- Recognized worldwide by stable managers, breeders, veterinarians and horse owners as the very safest for horses
- V-mesh weave protects hooves or legs from becoming caught in the fence
- Flexes on impact preventing breakage or failure
- Continuous weave pattern means no cut wire ends to harm animals
- Very effective predator control
- Quality galvanized wire with durable zinc coating resists weathering as well as wear and tear
- Easy to install on flat or hilly terrain
- Strong mesh design minimizes potential for injury by flexing on impact
- Horizontal Wire: 12 1/2 Gauge
- Vertical Wire: 14 Gauge
- Line Wires: 15
- Resource #77856

100% American Made

zip code

#### Returns

#### Delivery

#### View More:

Product Type: [Horse Fence](#)

Brand: [Red Brand](#)

Collection: [Horse Fence](#)

# Ag Barn Pasture Fence

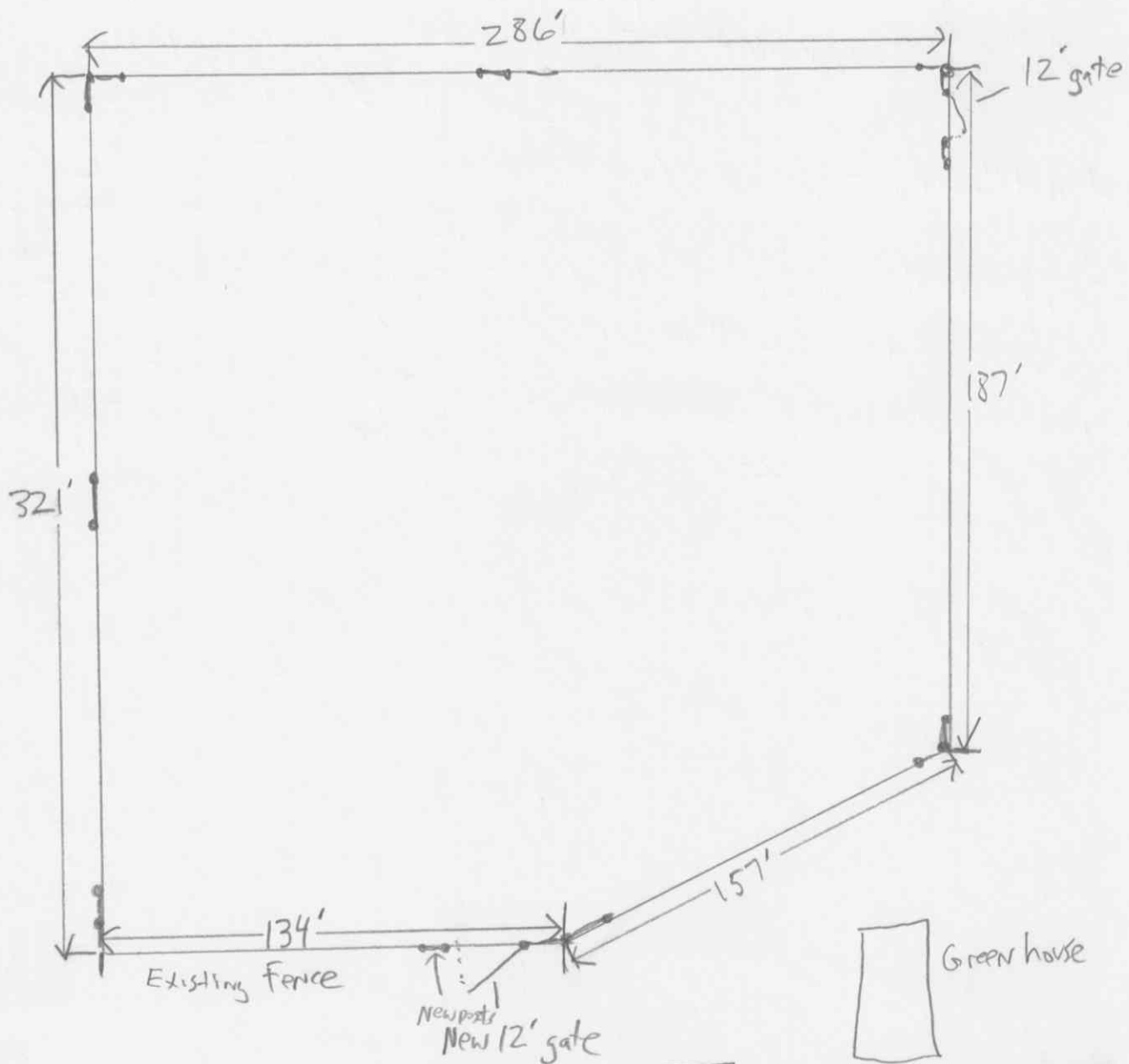

Distances are approximate and corners are staked. Contractors are to field verify all distances and conditions before providing a quote.